

SUBMERSIBLE LEVEL TRANSMITTER

series THLB6–a/b, THILB6-a/b

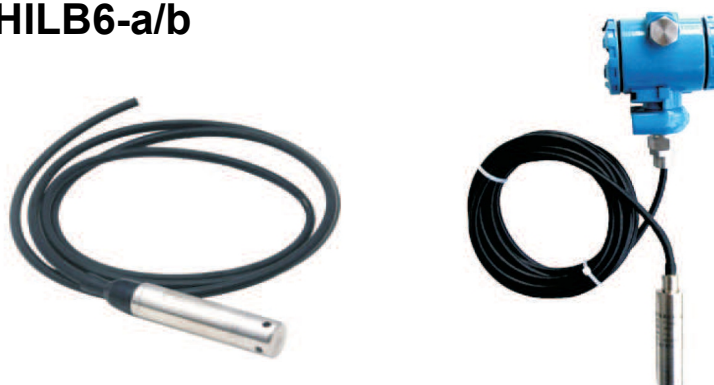

Specification:

THLB6 series submersible liquid level transmitter is made from stainless steel with rigid and robust construction. The protection cap with a small hole not only protect the diaphragm, but also let the liquids contact the diaphragm freely. The exquisite sealing technology as well as good assembly techniques guarantee THLB6 level transmitter's outstanding quality & performance. The product has a waterproof cable with vent hose which is designed for submersible applications. THLB6 series is designed with IP68 protection, it is widely applied in petroleum, chemical industry, medicine, metallurgy, hydrology exploration etc.

Description:

- Rigid and robust construction, IP68 protection
- Wide application scope, long service life
- Reversed polarity protection and current limiting protection
- Against thunder stroke, against radio-frequency interference
- Intrinsic safety, or flame-proof safety optional

TECHNICAL PARAMETERS			
Measuring ranges	0~1mH ₂ O...200mH ₂ O	Supply voltage	12~36VDC
Overload pressure	200%FS	Compensated temperature range	0~70℃
Pressure type	gauge(G), absolute(A)	Storage temperature range	-40~+100℃
Accuracy	0.1%FS, 0.25%FS /standard/ 0.5%FS	Electrical connection	Φ7.6mm shielded cable with vent hose
Output signal	4~20mA, 0~5V, 0~10V, 1~5V 4~20mA HART / THILB6	Material of wetted part and housing	321
Load resistance	RL=(U-12V)/0.02A(4~20mA current output) U—loop voltage V	Material of pressure membrane	316L or tantalum
Long-term stability	<0.1%FS/year	Sealing	n-Butyronitrile or fluoro-rubber sealing ring

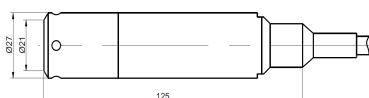

Order code:

THLB6					
Range	Pressure type	Accuracy	Output signal	Need explosive proof or not	



THLB6- a THILB6- a (HART)					
THLB6- b, THILB6-b (HART)					
	Range	measuring range: 0~1mH ₂ O...200mH ₂ O			
	(0~XmH ₂ O) L	X:actual measuring range L =cable length			
		Code	Pressure type		
		G	gauge		
		A	absolute		
			Code	Accuracy	
			B	0,1%	
			C	0,25%	
			D	0,5%	
				Code	Output signal
				O1	4 ~20mA
				O2	0 ~ 20mA
				O3	0 ~ 5V
				O4	1~ 5V
				O5	0 ~ 10V
				Oz	customer request
				Code	Need explosive proof or not
				N	not need explosive proof
				Y1	ATEX
				Y2	flame proof

THLB6	(0~20mH ₂ O)21	G	C	O1	N
	Range	Pressure type	Accuracy	Output signal	Need explosive proof or not



THLB6 - a



THLB6 - b