

RAIL VEHICLE PRESSURE GAUGE

diameters 80, 100 mm
back connection



DESCRIPTION:

- case Al cast/stainless steel
- glass or polycarbonate inspection hole
 - connection pin CuZn
- measurement mechanism CuZn

TECHNICAL PARAMETERS:

- diameter: 80, 100mm
- measure ranges: 0-10bar, 0-12bar, 0-16bar, other pressure range on request
- connection threads: G1/8 (G1/4; G3/8; G1/2; M12x1,5; M14x1,5; M16x1,5; M20x1,5)
 - accuracy class: 1,6%, 1%
 - protection: IP 54

SPECIFICATION:

Pressure gauges are produced in compliance with EN837-1 standard. Pressure gauges are designed for pressure measurements of gases and liquids of low viscosity with no solid admixtures. These mediums must not form crystals or have corrosive effect on copper alloys. Suitable for use on rail vehicles, mainly in break and fuel systems. Environment temperature -20 up to 60°C, medium temperature T_{max} 60°C. Gearing mechanism enables pressure transfer from the measurement mechanism element using the needle on the dial. Differential pressure gauge contains of two independently working measurement systems. Each measurement system has its own connection. Special gearing mechanism transfers each separate value by means of two needles with identical axis of rotation onto the same dial.

| | | | | |
|----------------------|--|--------------|--------|--------------------|
| Code | 620 | 6320 | 622 | 6322 |
| Diameter | 80mm | 80mm | 100mm | 100mm |
| Design | simple | differential | simple | differential |
| Accuracy class | 1,6%; 1% | | | |
| Ranges | 0-10bar; 0-12bar; 0-16 bar; other pressure range on request | | | |
| Working pressure | static 75% max. value of range; dynamic 65% max. value of range; overpressure max. 100% of range | | | |
| Temp.infl. on accur. | when the temperature of measured element deflects from 20 °C, $\pm 0,4\%/10K$ | | | |
| Humidity | 90% at 20 °C | | | |
| Mechanical load | tolerance to mechanical shocks in range 5-80Hz at amplitude max 1,5mm and acceleration max. 10g | | | |
| Measure mechanism | brass | | | |
| Dial | black, white print, zero value stop pin; other on request | | | |
| Needle | varnished aluminium; red, white, yellow; other on request | | | |
| Inspection hole | glass or polycarbonate | | | |
| Bourdon pen | CuZn | | | |
| Case | black varnished metal or stainless steel | | | |
| Attachment | panel mounting with a clamp or front flange | | | flange panel moun. |
| Connection | CuZn | | | |
| Thread | G1/8 (G1/4; G3/8; G1/2; M12x1,5; M14x1,5; M16x1,5; M20x1,5) | | | |
| Connection. | back | | | |
| IP protection | IP54 | | | |
| Illumination | optional LED diode system 24V, DC | | | |

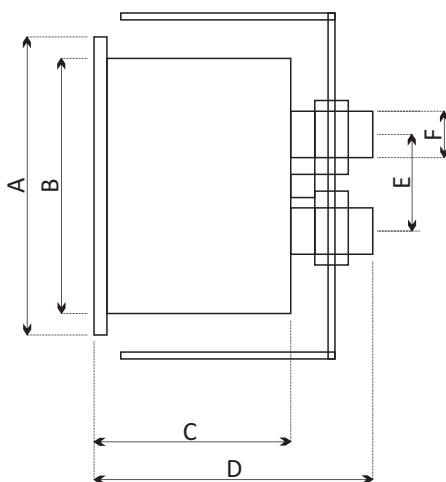

| Dimensions in mm | | | | | | |
|------------------|-----|----|----|-----|---------|--|
| Type | A | B | C | D* | E* | F |
| 620 | 85 | 79 | 38 | 83 | centric | G1/8; G1/4; G/8; G M12x1,5; M14x1,5, M16x1,5;M20x1,5 |
| 6320 | 85 | 79 | 60 | 105 | 36 | |
| 622 | 109 | 98 | 40 | 75 | centric | |
| 6320 | 109 | 98 | 75 | 150 | 50 | |

* may differ with connection thread type