

THREE-PHASE CAPILLARY THERMOSTAT series MMG

adjustable shaft
load 16A/400V

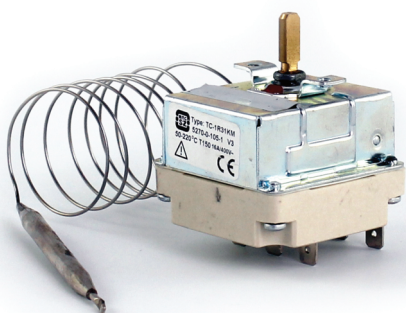

DESCRIPTION:

- design: 3 phase switch-off contact
- capillary material: stainless steel with PVC protection
 - sensor material: stainless steel

TECHNICAL PARAMETERS:

- temperature range: 50-220, 50-300°C
 - contact load: 16A/400V
 - switching difference: 10°C
- max. sensor temperature: 320°C
 - capillary length: 920mm
- contact load: 16(4)A 250V; 6(1)A 400V

SPECIFICATION:

Three-phase capillary thermostat automatically breaks a circuit when reaching preset temperature. When temperature drops, the thermostat connects the circuit again and systematically maintains the medium temperature by positions on/off. These thermostats are used mainly for washing machines, kitchen and industrial cookers, ovens, etc. Suitable for temperature control of gas, liquid and solid materials.

Type	5270-0-105-1	5270-0-105-1
Regulatory range (switch-off temp.)	50-220°C	50-300°C
Load	16A/400V	
Contact protection	I. (grounding)	
Protection	IP 00	
Connection	A 6,3 clamp stirrup	
Max. surrounding temp.	150°C	
Max. sensor surrounding temp.	upper switch-off temperature +15%	
Relative air temperature	30-80%	
Storing temperature	5-50°C	
Installation	inner	
Position of use	any	
Weight	80g	

Type	Regulatory range (°C)	Switching temp. difference (°C)	Sensor diameter (mm)	Sensor length (mm)	Capillary length (mm)
5270-0-101-4	50-300	10	4	168	920
5270-0-105-1	50-220	10	6	95	920

• Three-phase MMG thermostat

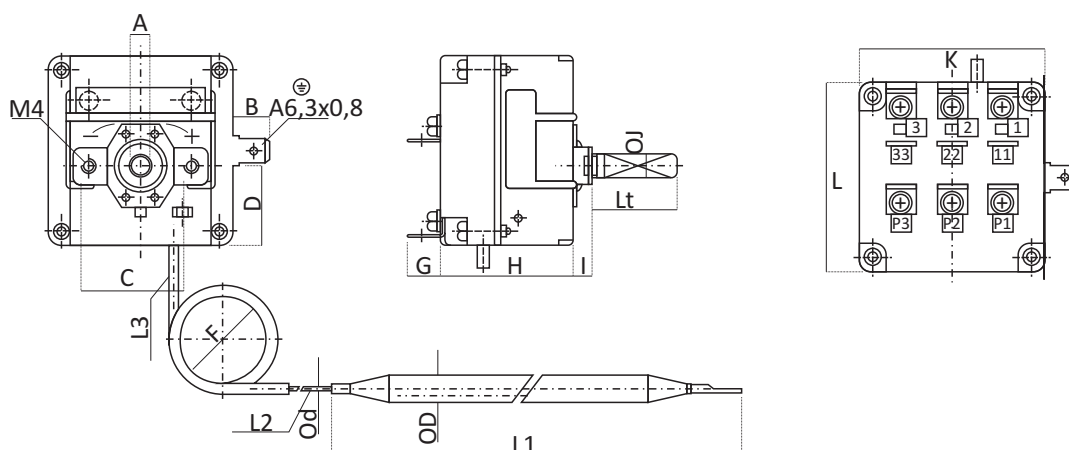

Dimensions in mm											
A	B	C	E	F	G	H	I	J	K	L	
4,6	10	28	21	30	9	36	5,5	6h11	50	50	

Wiring diagram

