

CASED STEM THERMOSTAT

series THS, DTHS

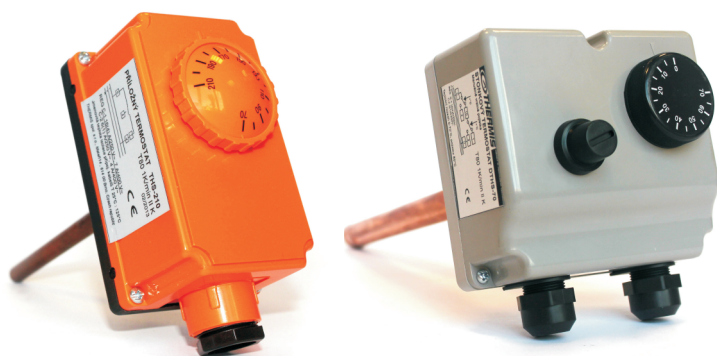

DESCRIPTION:

- design: stem, freely accessible regulation
 - mounting: well D8mm threaded G1/2
 - contacts: switch-on or switch-off
- PPTC reset (fuse): automatic reset Δt 20°C, manual reset

TECHNICAL PARAMETERS:

- temperature range: 0-90°C (THS 90)
40/70-210°C (THS 210)
0-70°C (DTHS 70)
30-90°C (DTHS 90)
 - fuse regulatory range DTHS:
90, 70-90, 110, 90-110°C
- temperature difference THS: 5 K
- stem length: 100-300mm (THS)
105-200mm (DTHS)
 - contact load:
C-1=16(4)A/250V~, 7A/400V~ (THS 90, 210),
16A/250V (DTHS 70/90)
- protection: IP 40 (THS), IP 44 (DTHS)

SPECIFICATION:

Stem thermostats THS 90/210 are designed for operation of electric appliances depending upon temperature of measured medium. Mounting is performed into heating system using copper protection well with thread G1/2. Suitable material is used for joint sealing, preferably teflon tape. Maximum permissible pressure on the well 10bar (1 MPa). Made in wide range of temperature ranges. Standard stem length 100mm (in case of need 200, 300mm). Stem thermostats DTHS 70/90 with PPTC fuse are designated for thermoregulation in liquid or other environment. In case of thermostats failure, the thermostats fuse automatically switches-off the circuit.

The fuse is part of this device. Fuse serves purely as a protection element, which may be manually turned-on after case removal or the automatic reset with Δt 20°C may be used.

Type	THS-90	THS-210
Regulatory range	0-90°C	40(70)-210°C
Temperature difference	5K	5K
Protection	IP 40	IP 40
Insulation class	I	I
Rate of temperature change	<1K/min	<1K/min
Stem length	100-300 mm	100-300 mm
Storing temperature	15-55°C	15-55°C
Contacts	switch-on or switch-off	switch-on or switch-off
Contact load	C-1=16(4)A/250V, 7A/400V	C-1=16(4)A/250V, 7A/400V
T _{max} case environment	80°C	80°C
T _{max} sensor	125°C	245°C
Mounting	well D8mm with thread G1/2	well D8mm with thread G1/2
Design	freely accessible regulation	freely accessible regulation

• THS

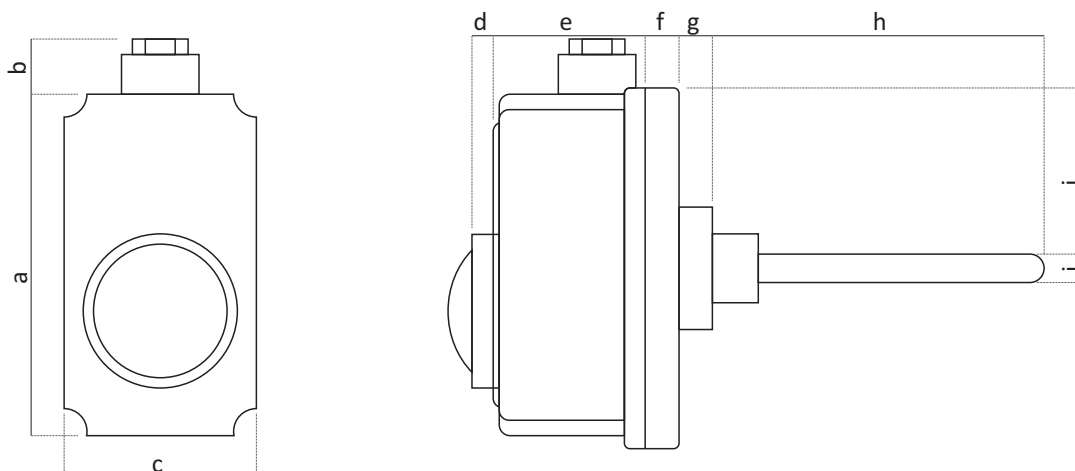

Dimensions in mm									
a	b	c	d	e	f	g	h	i	j
90	20	54	10	55	9	12	100	8	41

Wiring diagram

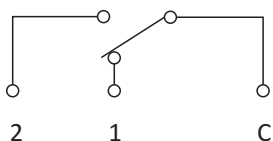

Type	DTHS-70A	DTHS-70M	DTHS-90A	DTHS-90M
Thermostat regulatory range	0-70°C	0-70°C	30-90°C	30-90°C
Fuse regulatory range	90°C	70-90°C	110°C	90-110°C
PPTC fuse reset	automatic Δt 20°C	manual reset	automatic Δt 20°C	manual reset
Setting accuracy	$\pm 5^\circ\text{C}$	$\pm 5^\circ\text{C}$	$\pm 5^\circ\text{C}$	$\pm 5^\circ\text{C}$
Stem length	105/200mm	105/200mm	105/200mm	105/200mm
Contact load	16A/250V	16A/250V	16A/250V	16A/250V
Weight	0,52kg	0,52kg	0,52kg	0,52kg
Design	freely accessible regulation		freely accessible regulation	

- DTHS

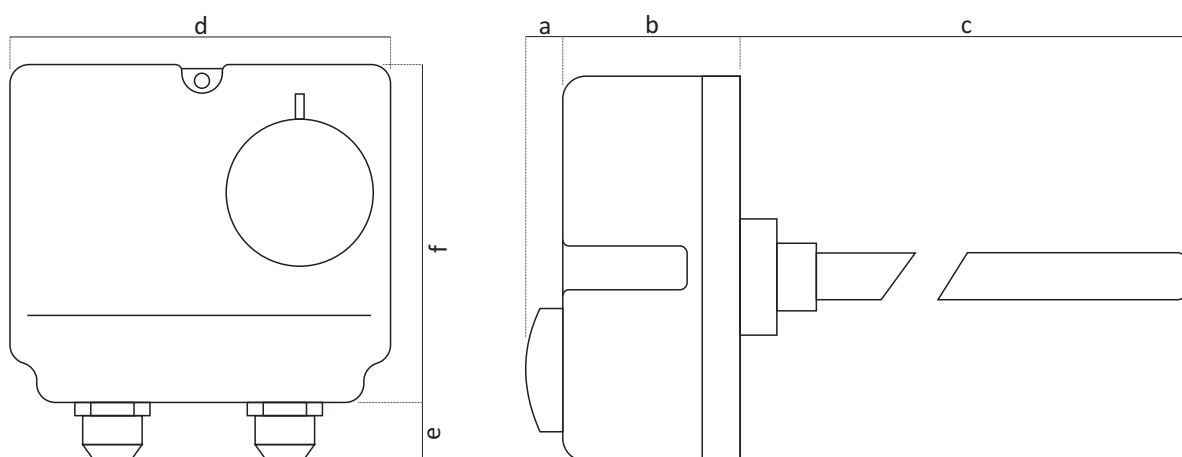

Dimensions in mm					
a	b	c	d	e	f
10	45	220	100	20	90

Wiring diagram

