

FLOWMETER LZM-G

float flowmeter
rate of flow:

0,5 l/h - 750 l/h liquid
1 m³/h - 1400 m³/h gas



DESCRIPTION:

- case: plastic (PC, PSU)
- connection material: plastic, PVC, polypropylen brass, stainless steel, chromium-plated brass
- float material: stainless steel
- guide rod material: stainless steel
- sealing: O-ring NBR or Al
- installation: only vertical
- option of liquid (water) and gases (air) measuring

APPLICATION:

- power engineering
- air-conditioning
- food industry
- mechanical engineering
- water management

TECHNICAL PARAMETERS:

- design: 15G, 20G, 25G, 40G, 50G
- measuring ranges: 0,5-4, 1-7, 1,8-18, 4-36, 10-70, 20-100, 20-110, 20-150, 80-220, 80-300, 150-450, 190-560, 220-750 l/min (water)
- 1-10, 1,6-16, 4-40, 6-60, 16-160, 25-250, 35-350, 80-400, 10-500, 120-600, 30-850, 400-1200, 500-1400 m³/h (air)
- T max: 90°C
- PN: 6 bar
- connection thread: G1/2 (G3/4, G1, G2)
- accuracy class: 4%

SPECIFICATION:

Tube-float flowmeters LZM-G are threaded, tube flowmeters, which are used in applications, where it is necessary to measure instantaneous flow. Flowmeters are designed for liquid (water) or gases (air) measurements. Flowmeter works on principle of float with orifice plate inside a closed cylindric measuring tube. Flowmeters are equipped with scale liter/min. Connection of the flowmeter is arranged as inner or outer thread G1/2 - 1". Vertical instalation only.

Type	Measuring range		Thread		Case	Connection	Float	Accuracy class
	l/min liquid (H ₂ O)	m ³ /hour gas						
LZM-15G	0,5-4	1-10	G1/2"	1/2"BSP	plastic (PC, PSU)	ABS, PVC polypropyl., brass, stainless steel, chromium-plated. brass	stainless steel	4%
LZM-15G	1-7	1,6-16	G1/2"	1/2"BSP				
LZM-15G	1,8-18	4-40	G1/2"	1/2"BSP				
LZM-20G	4-36	6-60	G3/4"	3/4"BSP				
LZM-25G	10-70	16-160	G1"	1"BSP				
LZM-25G	20-100	25-250	G1"	1"BSP				
LZM-25G	20-150	35-350	G1"	1"BSP				
LZM-40G	20-110	25-250	G1"	1 1/2"BSP				
LZM-40G	20-150	35-350	G1"	1 1/2"BSP				
LZM-40G	80-220	80-400	G2"	2"BSP				
LZM-50G	80-300	100-500	G2"	2"BSP				
LZM-50G	80-360	120-600	G2"	2"BSP				
LZM-50G	150-450	300-850	G2"	2"BSP				
LZM-50G	190-560	400-1200	G2"	2"BSP				
LZM-50G	220-750	500-1400	G2"	2"BSP				

• LZM-G

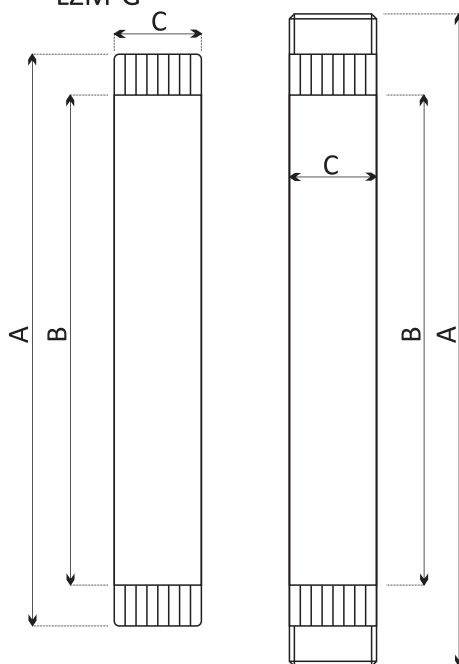

Dimensions in mm			
Type	A	B	C
LZM-15G	210	180	32
LZM-20G	278	236	45
LZM-25G	265	235	51
LZM-40G	306	235	51
LZM-50G	380	270	75