

## ELECTRONIC THERMOSTAT THP-E01

Function: switch/alarm









### DESCRIPTION:

- programmable menu
- switch between heating and cooling
- temperature control by the pre-set value and difference
  - mounting: onto wall
  - placement: common environment

### TECHNICAL PARAMETERS:

- default range: 0-99°C
- programmable range: -50-99°C
  - power supply: 230V
  - contact load: 10A/250V
- power consumption max 5W
  - IP protection: IP 44
- adjustable switch difference: 1-16 K
  - function: cooling/heating/alarm
  - compressor delay: 0-9 minutes
  - temperature correction: -5+5°C
    - adjustable range of setting

### COLOUR VERSIONS:

	silver		wood design
	ivory		blue
	orange		black

### SPECIFICATION:

Electronic thermostats are mainly used in applications, where the emphasis is put on visual aspect and easy control, or where it is convenient to prevent direct contact with the contacts. Main advantages of these thermostats are easy control, mounting and reliability. Widely used for switching of boiler circulation pump. Thermostats THP-E01 feature change-over contact for connection and disconnection of electric circuit. While using thermostat THP-E01 it is possible to set the switching difference. The thermostat is supplied with sensor, power cable and cable for connecting the pump.

Type	THP-E01
Regulatory range	-50°C - 99°C
Difference	1°C - 16°C adjustable
Power consumption	max. 5W
IP protection	IP 44
Max. upper environ. temp.	60°C
Storing temperature	-30°C - 60°C
Accuracy	±1°C
Installation placement	common environment
Output	contact switch on/off
Contact load	10A/250V

## • THP-E01

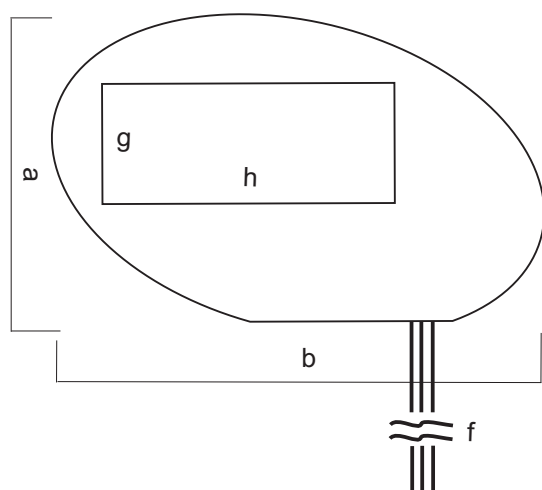

senzor, pump, power cable

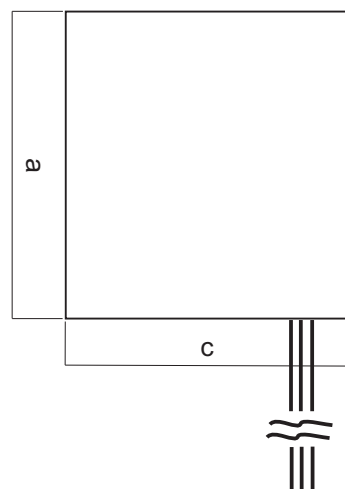

## • Console

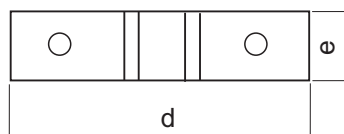

Dimensions in mm							
a	b	c	d	e	f	g	h
80	125	70	70	20	2000	25	70